

# Keypoint

*Hand and Foot Protection Specialists*



## Footwear Product Catalogue



+353 (0) 1 885 30 30  
[www.keypoint-uk.co.uk](http://www.keypoint-uk.co.uk)

## Contents

About Us .....	3
Footwear	
Action in Safety .....	4
OutDry® .....	5
Arch Support from Sixton® .....	6
Which Arch Support is Right for Me? .....	7
Technology .....	8
Technology .....	9
Avalon .....	10
Montana OutDry® Fur Lined .....	11
Stelvio .....	12
Stelvio Brown .....	13
Stelvio Black .....	14
Corvara Black .....	15
Antares .....	16
Illinois .....	17
Dealer .....	18
Auckland .....	19
Auckland High .....	20
Cuban .....	21
Swing .....	22
Kentucky .....	23
Cima .....	24
Cima .....	25
Bergamo .....	26
Venezia .....	27

Please be aware that the entire brochure is subject to modifications and amendments.

Established in Ireland in 2002, Keypoint is a specialist provider of industrial work gloves and safety footwear, servicing markets in both Ireland and the United Kingdom. A wholly Irish owned independent company, Keypoint has built a market leading position through combining world-renowned brands with a strong customer service ethos.

As the exclusive sales partner for ATG® Intelligent Glove Solutions, SW Safety Solutions and Sixton safety footwear, we are the first port of call for all leading PPE distributors when their customers require the best solution for hand and foot protection. Through our partnerships with the world's most innovative integrated manufacturers, we are always in a position to deliver market leading protection solutions that evolve and develop in line with changing market requirements.

Our products consistently lead the way in comfort, performance and wearer acceptance, with our long-term goal to make the industrial workplace a better, safer environment for all.

### Contact Us

17-18 Keypoint Business Park  
Rosemount Park Drive  
Ballycoolin Road, D11  
D11 K6NK

*Tel:* +353 (0) 1 885 30 30

*Fax:* +353 (0) 1 885 30 31

*Email:* [sales@keypoint.ie](mailto:sales@keypoint.ie)

#### **UK**

[www.keypoint-uk.co.uk](http://www.keypoint-uk.co.uk)

#### **Ireland**

[www.keypoint.ie](http://www.keypoint.ie)



**dynamicControl**  
technology

dynamicHCcontrol  
technology

"Dynamic Control", thanks to its design and manufacture, provides a clear example of a philosophy, based around protective footwear. The plastic inserts protect the wearer's ankle further from sharp objects and protrusions. And the rigid structure improves the way your foot rests on the ground, and ankle control of sideways movements.

**STABIL•ACTIVE**

The rigid plastic support inserted into the sole beneath the heel and waist provides greater stability and support of the arch, consequently improving foot posture.

**K+ ANTI PERFORATION PLUS**

New anti-perforation fabric inserts, reinforced with fibers, which have an improved performance compared to normal inserts. They are resistant to fine carpentry nails as required by the specifications in the latest update to EN 12568.

**SPUNTERBO**

Scuff cap.



**DUALMICRO DNVWICKBO**

Non-slip microfibre will resist more than 200,000 Martindale cycles.

Anti-debris

**alu-sxt2.0**  
aluminium

The result of the evolution of the latest aluminium technologies. A new multi-thicknesses toecap, which delivers a highly performing protection where needed. Ultralight protection, keeping comfortable inner volumes.

**WED**  
Wire Electricity Discharge

Strip with conductive carbon filaments. In contact with the foot, this feature ensures anti-static footwear over time, with any type of hygienic insole.

**SRC**

In terms of non-slip, standard EN ISO 20345:2011 states that the footwear must pass tests on 2 different surfaces with classifications related to the individual tests, SRA or SRB. As the requirements of both tests are passed, SRA and SRB, all the Sixton® PEAK footwear is awarded SRC non-slip certification.

An innovative lamination process is used to laminate a membrane directly onto the inner surface of the uppers & completely seals every potential point where water could get in. OutDry® greatly improves performance & comfort compared to traditional membranes used in combination with a lining.

## Features & Benefits

- It leaves no space between the upper and the membrane and does not allow water to penetrate into the shoe. There is therefore no increase in weight and the footwear dries more quickly.
- Designed specifically for foot protection, it uses a hydrophilic membrane that is extremely breathable and has a high sweat dispersion capability (SATRA TM 47 test). It leaves an ample dry air space between the membrane and foot, allowing ideal conditions to be maintained.
- The OutDry® membrane has an exceptional elasticity and resistance to repeated flexing.

## OutDry® Technology



## Other Technology



- A:** Shell
- B:** Membrane
- C:** Sweat
- D:** Trapped Sweat
- E:** Absorbed Water

## OutDry®: A Waterproof Breathable Barrier

Sixton® has been using the OutDry® waterproofing system for many years in the production of its Water Resistant footwear. With the “bootie” system used in traditional footwear, water is able to find its way between the uppers and the lining and stagnates there, even if it doesn’t reach the foot. This results in discomfort and makes the shoe heavier. Condensation of the water also increases the sensation of cold and in low temperatures it can also freeze. Drying times are long and complete drying is difficult to achieve, making the footwear unusable for long periods. The OutDry® technology overcomes these problems. The waterproof membrane is bonded to the uppers, preventing the passage of water, leaving the inner lining intact and the space around the foot dry.

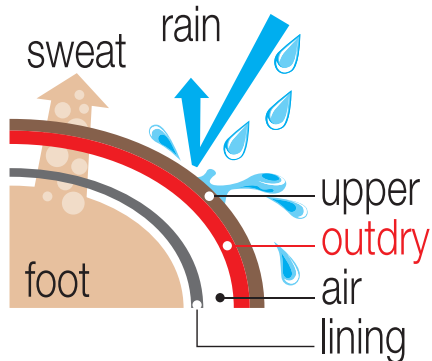

If you're on your feet for most of the day then you know how important the fit of your shoes are to the comfort of your feet. You might even be experiencing foot pain or suffering from common foot problems already. Using arch supports will help reduce your foot pain and make walking & standing much more comfortable by distributing pressure across your arches and provide stability, balance, and support.

### Benefits of wearing arch supports:

- **Provide stability and balance.** Arch supports can help improve your posture and balance which can help reduce foot pain and problems related to imbalance of the spine as well as from a lack of proper foot support.
- **Reduce or prevent pain.** Not all foot pain is from lack of stability. Arch supports can help reduce your foot pain or discomfort from standing for long periods of time.
- **Distributes pressure.** Arch supports evenly distribute pressure across your feet and align your body.
- **Provide support.** For those who require specialised support, their feet ailments may demand that they use artificial supports. These can help to alleviate pain and/or prevent further damage. This might be especially beneficial for those who suffer from plantar fasciitis (Plantar fasciitis is an inflammation of the fibrous tissue (plantar fascia) along the bottom of your foot that connects your heel bone to your toes).
- **Prevent your arches from harm.** Arch supports also provide support to your arches which prevent them from collapsing. Once they collapse, the plantar fascia might stretch which could lead to painful foot conditions such as plantar fasciitis.

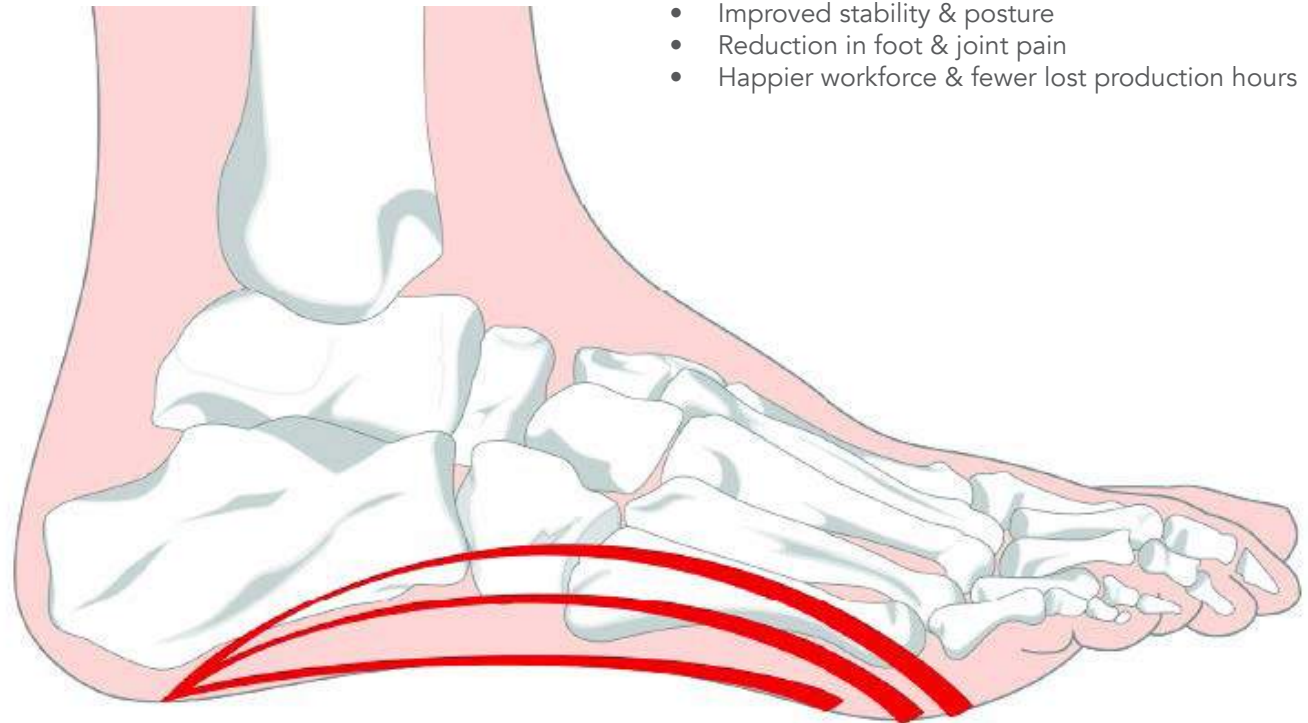

### More Comfort for Your Employees:

*Average Miles Walked Per Year:*

- Average Person: 390 – 520 miles
- Health Care Workers: 910 – 1,170 miles
- Farmers & Tradesmen: 1,300 – 1,560 miles

*Most important benefits in the industrial environment:*

- Better support, more comfort
- Improved stability & posture
- Reduction in foot & joint pain
- Happier workforce & fewer lost production hours

# Which Arch Supports Is Right For Me?

## Feetview

For people already suffering from chronic conditions of the feet or persistent pain, arch supports can help alleviate symptoms and assist in recovery. But how do you know which one to pick? With Feetview from Sixton® you can find out which Arch Support is right for you.

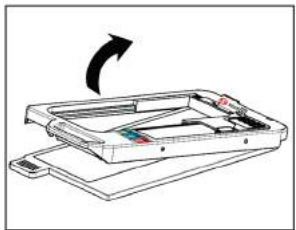

Open Unit

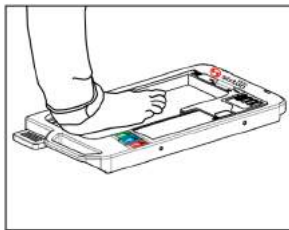

Place Foot

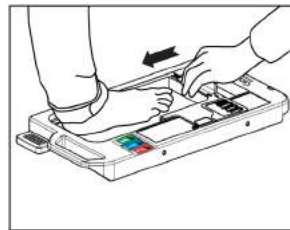

Measure Length

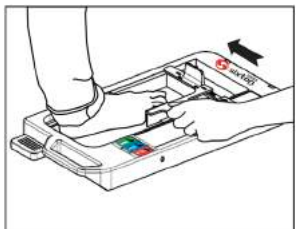

Measure Width

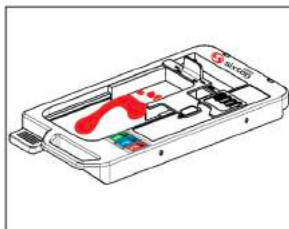

Analyse Print

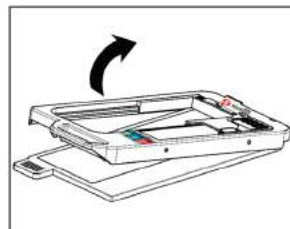

Erase Print



LOW ARCH SUPPORT



MEDIUM ARCH SUPPORT



HIGH ARCH SUPPORT



## 3D Air circulation

Sixton® chooses the best materials. Hi-tech fibres guarantee the best possible performance even right inside the footwear, which is less visible but so important for the wellbeing of the foot. The new 3D Air Ax lining is the result of the combination of two technical yarns, Amicor and Coolmax®.

## BLOWFIT

The upper part in FLYFIT, in direct contact with the foot, guarantees transpiration and comfort. By compressing and expanding, the perforated EVA part lets out the moist air, away from the foot, generating a flow of air, which improves comfort and the micro climate inside the footwear.



Anatomical and ergonomic removable insole with Flyfit, in direct contact with the foot, breathable, and comfortable. The EVA HD perforated and thermoformed support ensures comfort and energy absorption.



Composite Toe Cap- A toe cap made of plastic that is incredibly light and resistant to impacts over 200J.



Designed especially for winter use. It is made of highly resistant and absorbent felt, which keeps the foot warm and dry. A softer and comfortable layer of insulating polyethylene and a film of "aluminised" polyethylene contribute in perfectly insulating the foot from the ground. Perfect for winter use and for "CI" marked footwear for protection against cold.



Thanks to our production capacity and the common use of electronic devices, Sixton® extends its range of ESD footwear, in compliance with the latest reference standards for EPA areas (IEC 61340-5-1:2016; IEC 61340-4-3:2017). Sixton® ESD footwear is designed and produced by using conductive materials which assure the perfect performance of electric characteristics throughout the whole lifespan of the footwear. Furthermore, it allows the substitution of the worn-out insole without any loss of ESD properties.



Highly breathable and absorbent anatomic insole. Multilayer structure to take advantage of the peculiarities of each component. The foot lies on a highly breathable and wear resistant soft cloth layer. Right below, a comfortable memory foam layer hosts the foot respecting its anatomy. 3 layers of different materials to support the body in a correct and progressive way.



A multilayer material, humidity absorbent, self-forming, and stabilizing insole.



This symbol means that the shoe was made with a High Anti-Bacterial Component.



This symbol means that the product has been made using materials other than metal.



Micro Fiber XTop and Micro Fiber Suede are innovative technical microfibers with a high technological content, made specifically for the safety footwear industry. They are the result of research that has allowed us to attain high wear resistance and eco-compatibility with new high performance finishes. Fiber XTop, for S2 footwear, is water repellent, breathable and has a high dimensional stability. Micro Fiber Suede is synonymous with pleasant to the touch. It is soft, breathable and extremely comfortable. Sixton® Microfibers are extremely hard wearing.



Phthalates are substances added to plastics to increase their flexibility, transparency, durability, and longevity. They are used primarily to soften polyvinyl chloride (PVC). This symbol means that product has been made with out these substances.



Primaloft Footwear keeps your feet dry at all times, warm and comfortable, even in wet condition. Since staying dry is not always an option, it's good to know that Primaloft keeps feet warmer than any other natural or synthetic insulation when wet. Our footwear technology combines a unique blend of ultra fine multi-diameter fibers in a proprietary process. The specially treated and water resistant ultra fine fibers form a dynamic insulation structure, and the multi-diameter fibers build resiliency. The fibers structure is then bonded together to form a torsionally strong, breathable and water resistant insulating core. This structure has more compression resistance and maintains more loft for better fit. Greater durability and warm.



The upper part in FLYFIT, in direct contact with the foot, guarantees transpiration and comfort. Another thermoformed supporting layer of EVA HD, with large holes in the area where the heel sits, supports the heel correctly. By compressing and expanding, it lets out the moist air, away from the foot, generating a flow of air inside the footwear.



Anatomic 4-layer insoles with modular supports. A stronger layer to support the body weight on the heel area when standing. A softer one to follow the movement of the foot arch. A comfortable "memory" layer covered with breathable and absorbent "Flyfit" to host the foot.



Steel protection with anti-corrosion paint. Protection of over 200J. Comfortable fit, with compensation rubber. Stainless steel foil with acid-resistant paint.



The microfiber/tissue on the toe cap is protected by Pro-Tech SXT to increase the resistance of the upper over time.



# Logo Descriptions

# Technology



This shoe is recommended for working environments with classification "light": Automotive, logistics, transport, light industry.



A multilayer of form and function. The upper Flyfit part in direct contact with the foot guarantees breathability and comfort. The underlying PU support, with special cell configuration, supports the heel area excellently and creates a forced vertical flow of air, without altering its original shape over time, even after extensive use.



Vibram® is a world-class leading producer of high performance rubber soles. For over 70 years, the unmistakable yellow eight-sided brand, known across the globe, is the symbol of a company that is synonymous with quality, performance, safety, innovation and design. Sixton®/Vibram® health & safety soles are devised to satisfy the specific requirements of protection at workplaces. Each new product is designed to meet an exact purpose excellently, with the best mixes and with a triple quality target to be reached: best performance, maximum level of comfort and quality that lasts over time. Sixton® Peak® and Vibram® mean absolute "safety". Stability, heat and slip resistance, insulating properties and flexibility of use, are features that contribute in making the work of anyone who wears footwear with Sixton® / Vibram® sole really safe.



Vibram® Arctic Grip is a brand new approach to the grip on icy surfaces (specifically on wet ice). The technology involves Vibram® rubber alone, without the need to add external metal accessories. All the models feature designated lugs with Vibram® Arctic Grip sole technology that grips slick, wet ice, as well as thermo-chromatic lugs, which sense when the temperature drops to 32 °F / 0 °C, adding a splash of color in cold conditions.



Designed to improve grip on smooth, cold, icy or snow-covered ground. It leaves you free to move around and work in safety in the mountains and in particularly cold places. It does not scratch or ruin floors. The softness of the insole adheres to smooth surfaces. The aggressive design considerably improves traction and cleaning. Grip, durability and comfort by Vibram® and Sixton®.



ANTIPERFORATION

Textile anti-perforation insert. Resistant to over 100N with zero perforation



200 Joule Resistant Toe Cap



Shock Absorption in the Heel Area



Sole Resistant to Oil and Hydrocarbons



Anti-Static Footwear

WRU



Water Repellent Upper

AIRY



Breathable Upper

P



Anti-Perforation Protection

WR



Water Resistant Footwear

HRO



Sole Resistant to Heat by Contact

CI



Insulation Against the Cold

HI



Heat Insulation

M



Metatarsal Protection

SRC



Anti-Slippery

## Features & Benefits

- Fully waterproof boot through the use of OutDry® technology.
- Vibram® Ictrek sole compound improves grip on smooth, cold, icy or snow-covered ground. It does not scratch or ruin floors. It adheres to smooth surfaces and improves traction and cleaning.
- New outsole design with better self-cleaning reliefs and a step rest.
- PU/Rubber sole with scuff cap, resistant to heat contact up to 300° C, oil and hydrocarbons.
- K+ Anti Perforation Plus – a reinforced anti-perforation fabric insert that is resistant to fine carpentry nails and is compliant to the latest update to EN12568.
- Dynamic Control Technology – a rigid insert at the heel protects the ankle from sharp objects, controls ankle movement and improves the foot's resting position on the ground.
- Stabil Active – a rigid support on the base of the shoe provides greater stability and support for the arch of your foot, therefore improving foot posture.
- Anti Debris – closed construction prevents irritating objects and dirt from entering the shoe and seeping into your socks.
- WED (wire electricity discharge) – a conductive strip integrated into the shoe ensuring that regardless of the insoles used, the shoe maintains its anti-static properties.



<b>Style</b>	Avalon
<b>Range</b>	Polar
<b>Type</b>	Hi-Leg
<b>Upper</b>	Microfiber
<b>Lining</b>	3D Air Circulation
<b>Insole</b>	Dual Insulation
<b>Sole</b>	PU/Rubber Vibram® – Ictrek
<b>Toe cap</b>	CTC Composite Toe Cap
<b>Midsole</b>	Zero (k) Anti-Perforation
<b>Size</b>	38-48
<b>Weight</b>	860gr
<b>Specification</b>	S3 HRO HI WR SRC
<b>Colour</b>	Black
<b>EN</b>	ISO 20345:2011

## Industries



# Montana OutDry® Fur Lined

81156-23

## Features & Benefits

- Fully waterproof boot through the use of OutDry® technology.
- PU Dual Density Outsole which is anti slip with self cleaning reliefs, and a step rest. Resistant to oil and hydrocarbons.
- Dynamic Control Technology – a rigid insert at the heel protects the ankle from sharp objects, controls ankle movement and improves the foot's resting position on the ground.
- Stabil Active – a rigid support on the base of the shoe provides greater stability and support for the arch of your foot, therefore improving foot posture.
- Anti Debris – closed construction prevents irritating objects and dirt from entering the shoe and seeping into your socks.
- WED (wire electricity discharge) – a conductive strip integrated into the shoe ensuring that regardless of the insoles used, the shoe maintains its anti-static properties



<b>Style</b>	Montana OutDry® Fur Lined
<b>Range</b>	Endurance
<b>Type</b>	Rigger
<b>Upper</b>	Greased Nubuk Leather Hydrotech
<b>Lining</b>	Genuine Wool Polar
<b>Insole</b>	Dual Insulation
<b>Sole</b>	PU/Dual Density SRC
<b>Toe cap</b>	CTC Composite Toe Cap
<b>Midsole</b>	K+, Anti-Perforation – Composite
<b>Size</b>	38-48
<b>Weight</b>	850gr
<b>Specification</b>	S3 WR CI SRC
<b>Colour</b>	Brown
<b>EN</b>	ISO 20345:2011

## Industries



## Features & Benefits

- Fully waterproof boot through the use of OutDry® technology.
- New outsole design with better self-cleaning reliefs. Sole includes a Step Rest and is resistant to oil and hydrocarbons.
- PU/Rubber sole with scuff cap, resistant to heat contact up to 300° C.
- Dynamic Control Technology – a rigid insert at the heel protects the ankle from sharp objects, controls ankle movement and improves the foot's resting position on the ground.
- Stabil Active – a rigid support on the base of the shoe provides greater stability and support for the arch of your foot, therefore improving foot posture.
- Anti Debris – closed construction prevents irritating objects and dirt from entering the shoe and seeping into your socks.
- WED (wire electricity discharge) – a conductive strip integrated into the shoe ensuring that regardless of the insoles used, the shoe maintains its anti-static properties.



<b>Style</b>	Stelvio
<b>Range</b>	Polar
<b>Type</b>	6" Boot
<b>Upper</b>	Greased Nubuk Leather Hydrotech
<b>Lining</b>	3D Air Circulation
<b>Insole</b>	Blowfit 2.0
<b>Sole</b>	PU/Rubber Vibram®
<b>Toe cap</b>	CTC Composite Toe Cap
<b>Midsole</b>	Zero (k) Anti-Perforation
<b>Size</b>	38-48
<b>Weight</b>	865gr
<b>Specification</b>	S3 HRO HI WR SRC
<b>Colour</b>	Black
<b>EN</b>	ISO 20345:2011

## Industries



# Stelvio - Brown Boot

80087-01

## Features & Benefits

- Anti Slip self-cleaning outsole, with step rest.
- PU/Rubber sole with scuff cap, resistant to heat contact up to 300° C, acids and oil.
- Dynamic Control Technology – a rigid insert at the heel protects the ankle from sharp objects, controls ankle movement and improves the foot's resting position on the ground.
- Stabil Active – a rigid support on the base of the shoe provides greater stability and support for the arch of your foot, therefore improving foot posture.
- Anti Debris – closed construction prevents irritating objects and dirt from entering the shoe and seeping into your socks.
- WED (wire electricity discharge) – a conductive strip integrated into the shoe ensuring that regardless of the insoles used, the shoe maintains its anti-static properties.



<b>Style</b>	Stelvio
<b>Range</b>	Atlantida
<b>Type</b>	6" Boot
<b>Upper</b>	Greased Nubuk Leather Hydrotech
<b>Lining</b>	3D Air Circulation
<b>Insole</b>	Blowfit 2.0
<b>Sole</b>	PU/Rubber Vibram®
<b>Toe cap</b>	CTC Composite Toe Cap
<b>Midsole</b>	Zero (k) Anti-Perforation
<b>Size</b>	38-48
<b>Weight</b>	765gr
<b>Specification</b>	S3 HRO HI SRC
<b>Colour</b>	Brown
<b>EN</b>	ISO 20345:2011

## Industries



# Stelvio - Black Boot

80087-00

## Features & Benefits

- Anti Slip self-cleaning outsole, with step rest.
- PU/Rubber sole with scuff cap, resistant to heat contact up to 300° C, acids and oil.
- Dynamic Control Technology – a rigid insert at the heel protects the ankle from sharp objects, controls ankle movement and improves the foot's resting position on the ground.
- Stabil Active – a rigid support on the base of the shoe provides greater stability and support for the arch of your foot, therefore improving foot posture.
- Anti Debris – closed construction prevents irritating objects and dirt from entering the shoe and seeping into your socks.
- WED (wire electricity discharge) – a conductive strip integrated into the shoe ensuring that regardless of the insoles used, the shoe maintains its anti-static properties



<b>Style</b>	Stelvio
<b>Range</b>	Atlantida
<b>Type</b>	6" Boot
<b>Upper</b>	Greased Nubuk Leather Hydrotech
<b>Lining</b>	3D Air Circulation
<b>Insole</b>	Blowfit 2.0
<b>Sole</b>	PU/Rubber Vibram®
<b>Toe cap</b>	CTC Composite Toe Cap
<b>Midsole</b>	Zero (k) Anti-Perforation
<b>Size</b>	38-48
<b>Weight</b>	765gr
<b>Specification</b>	S3 HRO HI SRC
<b>Colour</b>	Black
<b>EN</b>	ISO 20345:2011

## Industries



# Corvara - Black Boot

81087-06

## Features & Benefits

- Sturdy, comfortable and extremely light boot.
- PU Dual Density Outsole which is anti slip with self cleaning reliefs, and a step rest. Resistant to oil and hydrocarbons.
- Dynamic Control Technology – a rigid insert at the heel protects the ankle from sharp objects, controls ankle movement and improves the foot's resting position on the ground.
- Stabil Active – a rigid support on the base of the shoe provides greater stability and support for the arch of your foot, therefore improving foot posture.
- Anti Debris – closed construction prevents irritating objects and dirt from entering the shoe and seeping into your socks.
- WED (wire electricity discharge) – a conductive strip integrated into the shoe ensuring that regardless of the insoles used, the shoe maintains its anti-static properties.



<b>Style</b>	Corvara
<b>Range</b>	Endurance
<b>Type</b>	6" Boot
<b>Upper</b>	Greased Nubuk Leather Hydrotech
<b>Lining</b>	3D Air Circulation
<b>Insole</b>	Blowfit 2.0
<b>Sole</b>	PU Dual Density SRC
<b>Toe cap</b>	CTC Composite Toe Cap
<b>Midsole</b>	K+, Anti -Perforation – Composite
<b>Size</b>	38-48
<b>Weight</b>	715gr
<b>Specification</b>	S3 SRC
<b>Colour</b>	Black
<b>EN</b>	ISO 20345:2011

## Industries



## Features & Benefits

- Very Light well balanced classic boot.
- PU Dual Density Outsole which is anti slip with self cleaning reliefs, and a step rest. Resistant to oil and hydrocarbons.
- Dynamic Control Technology – a rigid insert at the heel protects the ankle from sharp objects, controls ankle movement and improves the foot's resting position on the ground.
- Stabil Active – a rigid support on the base of the shoe provides greater stability and support for the arch of your foot, therefore improving foot posture.
- Anti Debris – closed construction prevents irritating objects and dirt from entering the shoe and seeping into your socks.
- WED (wire electricity discharge) – a conductive strip integrated into the shoe ensuring that regardless of the insoles used, the shoe maintains its anti-static properties.



<b>Style</b>	Antares
<b>Range</b>	Horizon
<b>Type</b>	6" Boot
<b>Upper</b>	Greased Nubuk Leather Hydrotech
<b>Lining</b>	Soft Full Grain Leather
<b>Insole</b>	Climation-Fit 337
<b>Sole</b>	PU Dual Density
<b>Toe cap</b>	Steel Toe Cap
<b>Midsole</b>	Steel Midsole
<b>Size</b>	36-48
<b>Weight</b>	710gr
<b>Specification</b>	S3 SRC
<b>Colour</b>	Black
<b>EN</b>	ISO 20345:2011

## Industries





## Features & Benefits

- Very Light well balanced classic boot.
- PU Dual Density Outsole which is anti slip with self cleaning reliefs, and a step rest. Resistant to oil and hydrocarbons.
- Dynamic Control Technology – a rigid insert at the heel protects the ankle from sharp objects, controls ankle movement and improves the foot's resting position on the ground.
- Stabil Active – a rigid support on the base of the shoe provides greater stability and support for the arch of your foot, therefore improving foot posture.
- Anti Debris – closed construction prevents irritating objects and dirt from entering the shoe and seeping into your socks.
- WED (wire electricity discharge) – a conductive strip integrated into the shoe ensuring that regardless of the insoles used, the shoe maintains its anti-static properties



<b>Style</b>	Illinois
<b>Range</b>	Horizon
<b>Type</b>	6" Boot
<b>Upper</b>	Full Grain leather Hydrotech
<b>Lining</b>	3D Air Circulation
<b>Insole</b>	Absorbent in foamed latex insole
<b>Sole</b>	PU Dual Density
<b>Toe cap</b>	Steel Toe Cap
<b>Midsole</b>	Steel Midsole
<b>Size</b>	36-48
<b>Weight</b>	700gr
<b>Specification</b>	S3 SRC
<b>Colour</b>	Black
<b>EN</b>	ISO 20345:2011

## Industries



## Features & Benefits

- Lightweight and comfortable boot with soft durable midsole for enhanced energy absorption in the heel.
- Dual Density PU sole gives optimum performance for slip resistance. Includes a step rest and is resistant to oil and hydrocarbons.
- K+ Anti Perforation Plus – a reinforced anti-perforation fabric insert that is resistant to fine carpentry nails and is compliant to the latest update to EN12568.
- Dynamic Control Technology – a rigid insert at the heel protects the ankle from sharp objects, controls ankle movement and improves the foot's resting position on the ground.
- Stabil Active – a rigid support on the base of the shoe provides greater stability and support for the arch of your foot, therefore improving foot posture.
- Anti Debris – closed construction prevents irritating objects and dirt from entering the shoe and seeping into your socks.
- WED (wire electricity discharge) – a conductive strip integrated into the shoe ensuring that regardless of the insoles used, the shoe maintains its anti-static properties.



<b>Style</b>	Dealer
<b>Range</b>	Touring
<b>Type</b>	Slip-on
<b>Upper</b>	Greased Nubuk Leather Hydrotech
<b>Lining</b>	3D Air Circulation
<b>Insole</b>	Blowfit 2.0
<b>Sole</b>	PU Dual Density
<b>Toe cap</b>	CTC Composite Toe Cap
<b>Midsole</b>	K+ Ant perforation Plus
<b>Size</b>	36-48
<b>Weight</b>	620gr
<b>Specification</b>	S3 SRC
<b>Colour</b>	Brown
<b>EN</b>	ISO 20345:2011

## Industries

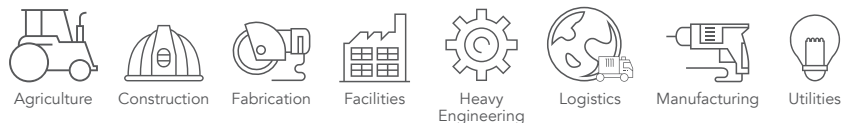

## Features & Benefits

- Light, and breathable trainer with a sporty design.
- ESD compliant for EPA Areas. Sixton® ESD footwear is designed to ensure perfect ESD performance for the life of the footwear. It also allows the substitution of the insole without any loss of ESD properties.
- New sole design specially developed for difficult surfaces, with self-cleaning reliefs and a flat surface to increase grip performance.
- K+ Anti Perforation Plus – a reinforced anti-perforation fabric insert that is resistant to fine carpentry nails and is compliant to the latest update to EN12568.
- Dynamic Control Technology – a rigid insert at the heel protects the ankle from sharp objects, controls ankle movement and improves the foot's resting position on the ground.
- Stabil Active – a rigid support on the base of the shoe provides greater stability and support for the arch of your foot, therefore improving foot posture.
- Anti Debris – closed construction prevents irritating objects and dirt from entering the shoe and seeping into your socks.
- WED (wire electricity discharge) – a conductive strip integrated into the shoe ensuring that regardless of the insoles used, the shoe maintains its anti-static properties.



<b>Style</b>	Auckland
<b>Range</b>	Skipper
<b>Type</b>	Trainer
<b>Upper</b>	No ladder, High Tenacity textile, WR
<b>Lining</b>	Breezy SD, two-layers combination
<b>Insole</b>	Soft-Fit
<b>Sole</b>	ESD-Plus SRC
<b>Toe cap</b>	Alu-SXT 2.0 Aluminium Toe Cap
<b>Midsole</b>	K+ Ant perforation Plus
<b>Size</b>	40-48
<b>Weight</b>	560gr
<b>Specification</b>	S3 SRC ESD
<b>Colour</b>	Black
<b>EN</b>	ISO 20345:2011 IEC 61340-5-1:2016 IEC 61340-4-3:2006

## Industries



## Features & Benefits

- Light, and breathable trainer with a sporty design.
- ESD compliant for EPA Areas. Sixton® ESD footwear is designed to ensure perfect ESD performance for the life of the footwear. It also allows the substitution of the insole without any loss of ESD properties.
- New sole design specially developed for difficult surfaces, with self-cleaning reliefs and a flat surface to increase grip performance.
- K+ Anti Perforation Plus – a reinforced anti-perforation fabric insert that is resistant to fine carpentry nails and is compliant to the latest update to EN12568.
- Dynamic Control Technology – a rigid insert at the heel protects the ankle from sharp objects, controls ankle movement and improves the foot's resting position on the ground.
- Stabil Active – a rigid support on the base of the shoe provides greater stability and support for the arch of your foot, therefore improving foot posture.
- Anti Debris – closed construction prevents irritating objects and dirt from entering the shoe and seeping into your socks.
- WED (wire electricity discharge) – a conductive strip integrated into the shoe ensuring that regardless of the insoles used, the shoe maintains its anti-static properties.



<b>Style</b>	Auckland
<b>Range</b>	Skipper
<b>Type</b>	Ankle Boot
<b>Upper</b>	No Ladder, High Tenacity Textile, WR
<b>Lining</b>	Breezy 3D, Two-Layers Combination
<b>Insole</b>	Soft-Fit Plus ESD
<b>Sole</b>	PU/PU ESD-Plus SRC Passed
<b>Toe cap</b>	Alu-SXT 2.0 Aluminium Toe Cap
<b>Midsole</b>	K+ Ant perforation Plus
<b>Size</b>	38-48
<b>Weight</b>	595gr
<b>Specification</b>	S3 SRC ESD
<b>Colour</b>	Black
<b>EN</b>	ISO 20345:2011 IEC 61340-5-1:2016 IEC 61340-4-3:2006

## Industries



## Features & Benefits

- Extremely light and comfortable trainer.
- PU/PU outsole has good abrasion resistance, making it very durable.
- Sole has self cleaning cleats with a step rest and is resistant to oil and hydrocarbons.
- Dynamic Control Technology – a rigid insert at the heel protects the ankle from sharp objects, controls ankle movement and improves the foot's resting position on the ground.
- Stabil Active – a rigid support on the base of the shoe provides greater stability and support for the of your foot, therefore improving foot posture.
- Anti Debris – closed construction prevents irritating objects and dirt from entering the shoe and seeping into your socks.
- WED (wire electricity discharge) – a conductive strip integrated into the shoe ensuring that regardless of the insoles used, the shoe maintains its anti-static properties.



<b>Style</b>	Cuban
<b>Range</b>	Ritmo
<b>Type</b>	Trainer
<b>Upper</b>	Microfiber Suede
<b>Lining</b>	3D Air Circulation 320 gr.
<b>Insole</b>	Soft-Fit
<b>Sole</b>	PU / PU ESD Plus SRC Passed
<b>Toe cap</b>	Alu-SXT 2.0 Aluminium Toe Cap
<b>Midsole</b>	Zero (k) Anti-Perforation
<b>Size</b>	35-48
<b>Weight</b>	520gr
<b>Specification</b>	S3 SRC ESD
<b>Colour</b>	Black
<b>EN</b>	ISO 20345:2011

## Industries



## Features & Benefits

- Extremely light and comfortable trainer.
- ESD compliant for EPA Areas. Sixton® ESD footwear is designed to ensure perfect ESD performance for the life of the footwear. It also allows the substitution of the insole without any loss of ESD properties.
- K+ Anti Perforation Plus – a reinforced anti-perforation fabric insert that is resistant to fine carpentry nails and is compliant to the latest update to EN12568.
- Dynamic Control Technology – a rigid insert at the heel protects the ankle from sharp objects, controls ankle movement and improves the foot's resting position on the ground.
- Stabil Active – a rigid support on the base of the shoe provides greater stability and support for the arch of your foot, therefore improving foot posture.
- Anti Debris – closed construction prevents irritating objects and dirt from entering the shoe and seeping into your socks.
- WED (wire electricity discharge) – a conductive strip integrated into the shoe ensuring that regardless of the insoles used, the shoe maintains its anti-static properties



<b>Style</b>	Swing
<b>Range</b>	Ritmo Cross
<b>Type</b>	Trainer
<b>Upper</b>	Greased Nubuk Leather Hydrotech
<b>Lining</b>	3D Air Circulation
<b>Insole</b>	Soft-Fit
<b>Sole</b>	ESD-Plus SRC
<b>Toe cap</b>	Alu-SXT 2.0 Aluminium Toe Cap
<b>Midsole</b>	K+ Anti-perforation Plus
<b>Size</b>	35-48
<b>Weight</b>	580gr
<b>Specification</b>	S3 SRC ESD
<b>Colour</b>	Black
<b>EN</b>	ISO 20345:2011

## Industries



## Features & Benefits

- Very Light well balanced classic boot.
- PU Dual Density Outsole which is anti slip with self cleaning reliefs, and a step rest. Resistant to oil and hydrocarbons.
- Dynamic Control Technology – a rigid insert at the heel protects the ankle from sharp objects, controls ankle movement and improves the foot's resting position on the ground.
- Stabil Active – a rigid support on the base of the shoe provides greater stability and support for the arch of your foot, therefore improving foot posture.
- Anti Debris – closed construction prevents irritating objects and dirt from entering the shoe and seeping into your socks.
- WED (wire electricity discharge) – a conductive strip integrated into the shoe ensuring that regardless of the insoles used, the shoe maintains its anti-static properties



<b>Style</b>	Kentucky
<b>Range</b>	Horizon
<b>Type</b>	Shoe
<b>Upper</b>	Full Grain leather Hydrotech
<b>Lining</b>	3D Air Circulation
<b>Insole</b>	Absorbent in foamed latex insole
<b>Sole</b>	PU Dual Density
<b>Toe cap</b>	Steel Toe Cap
<b>Midsole</b>	Steel Midsole
<b>Size</b>	36-48
<b>Weight</b>	610gr
<b>Specification</b>	S3 SRC
<b>Colour</b>	Black
<b>EN</b>	ISO 20345:2011

## Industries



STEELPROTECTION

PHTHALATEFREE

SPUNTERBO

## Features & Benefits

- New dual density PU sole is extremely light and flexible giving maximum comfort to the wearer whether standing or walking for long periods.
- Dynamic Control Technology – a rigid insert at the heel protects the ankle from sharp objects, controls ankle movement and improves the foot's resting position on the ground.
- Stabil Active – a rigid support on the base of the shoe provides greater stability and support for the arch of your foot, therefore improving foot posture.
- Anti Debris – closed construction prevents irritating objects and dirt from entering the shoe and seeping into your socks.
- WED (wire electricity discharge) – a conductive strip integrated into the shoe ensuring that regardless of the insoles used, the shoe maintains its anti-static properties



<b>Style</b>	Cima
<b>Range</b>	Skipper Lady
<b>Type</b>	Trainer
<b>Upper</b>	Airy, No Ladder, WRU H.T. Textile
<b>Lining</b>	Breezy 3D, Two-Layers Combination
<b>Insole</b>	Soft-Fit Plus ESD
<b>Sole</b>	PU Dual-Density SRC
<b>Toe cap</b>	Alu SXT 2.0
<b>Midsole</b>	K+ Anti-Perforation PLUS
<b>Size</b>	35-42 Lady
<b>Weight</b>	420gr
<b>Specification</b>	S3 SRC ESD
<b>Colour</b>	Black
<b>EN</b>	ISO 20345:2011 IEC EN 61340-5-1:2016 IEC EN 61340-4-3:2006

## Industries





## Features & Benefits

- New dual density PU sole is extremely light and flexible giving maximum comfort to the wearer whether standing or walking for long periods.
- Dynamic Control Technology – a rigid insert at the heel protects the ankle from sharp objects, controls ankle movement and improves the foot's resting position on the ground.
- Stabil Active – a rigid support on the base of the shoe provides greater stability and support for the arch of your foot, therefore improving foot posture.
- Anti Debris – closed construction prevents irritating objects and dirt from entering the shoe and seeping into your socks.
- WED (wire electricity discharge) – a conductive strip integrated into the shoe ensuring that regardless of the insoles used, the shoe maintains its anti-static properties



<b>Style</b>	Cima
<b>Range</b>	Skipper Lady
<b>Type</b>	Trainer
<b>Upper</b>	Airy, No Ladder, WRU H.T. Textile
<b>Lining</b>	Breezy 3D, Two-Layers Combination
<b>Insole</b>	Soft-Fit Plus ESD
<b>Sole</b>	PU Dual-Density SRC
<b>Toe cap</b>	Alu SXT 2.0
<b>Midsole</b>	K+ Anti-Perforation PLUS
<b>Size</b>	35-42 Lady
<b>Weight</b>	420gr
<b>Specification</b>	S1P SRC
<b>Colour</b>	Grey
<b>EN</b>	ISO 20345:2011 IEC EN 61340-5-1:2016 IEC EN 61340-4-3:2006

## Industries



Automotive



Electronics



Light Assembly



Logistics



## Features & Benefits

- Classic boot designed for food, hospital and pharmaceutical sectors.
- New dual density PU sole extremely light and flexible giving maximum comfort to the wearer whether standing or walking for long periods.
- Designed to increase the longitudinal and lateral grip.
- Non marking "Crystal" outsole with self cleaning reliefs and a step rest. Resistant to oil and hydrocarbons.
- Dynamic Control Technology – a rigid insert at the heel protects the ankle from sharp objects, controls ankle movement and improves the foot's resting position on the ground.
- Stabil Active – a rigid support on the base of the shoe provides greater stability and support for the arch of your foot, therefore improving foot posture.
- Anti Debris – closed construction prevents irritating objects and dirt from entering the shoe and seeping into your socks.
- WED (wire electricity discharge) – a conductive strip integrated into the shoe ensuring that regardless of the insoles used, the shoe maintains its anti-static properties.



<b>Style</b>	Bergamo
<b>Range</b>	Crystal
<b>Type</b>	6" Boot
<b>Upper</b>	Microfiber Xtop
<b>Lining</b>	Bacteriostatic Teklife 3D
<b>Insole</b>	Flyfit
<b>Sole</b>	PU Dual Density
<b>Toe cap</b>	CTC Composite Toe Cap
<b>Midsole</b>	None
<b>Size</b>	35-48
<b>Weight</b>	510gr
<b>Specification</b>	S2 SRC
<b>Colour</b>	White
<b>EN</b>	ISO 20345:2011

## Industries



Food

Pharmaceutical



## Features & Benefits

- Classic shoe designed for food,, hospital and pharmaceutical sectors.
- New dual density PU sole ex extremely light and flexible giving maximum comfort to the wearer whether standing or walking for long periods.
- Designed to increase the longitudinal and lateral grip.
- Non marking "Crystal" outsole with self cleaning reliefs and a step rest. Resistant to oil and hydrocarbons.
- Dynamic Control Technology – a rigid insert at the heel protects the ankle from sharp objects, controls ankle movement and improves the foot's resting position on the ground.
- Stabil Active – a rigid support on the base of the shoe provides greater stability and support for the arch of your foot, therefore improving foot posture.
- Anti Debris – closed construction prevents irritating objects and dirt from entering the shoe and seeping into your socks.
- WED (wire electricity discharge) – a conductive strip integrated into the shoe ensuring that regardless of the insoles used, the shoe maintains its anti-static properties



<b>Style</b>	Venezia
<b>Range</b>	Crystal
<b>Type</b>	Slip-on
<b>Upper</b>	Microfiber X-Top
<b>Lining</b>	Bacteriostatic Teklife 3D
<b>Insole</b>	Flyfit
<b>Sole</b>	PU Dual Density
<b>Toe cap</b>	CTC Composite Toe Cap
<b>Midsole</b>	None
<b>Size</b>	35-48
<b>Weight</b>	460gr
<b>Specification</b>	S2 SRC
<b>Colour</b>	White
<b>EN</b>	ISO 20345:2011

## Industries



Food



Pharmaceutical

